

Section II.

TM 9-2320-272-34P-1

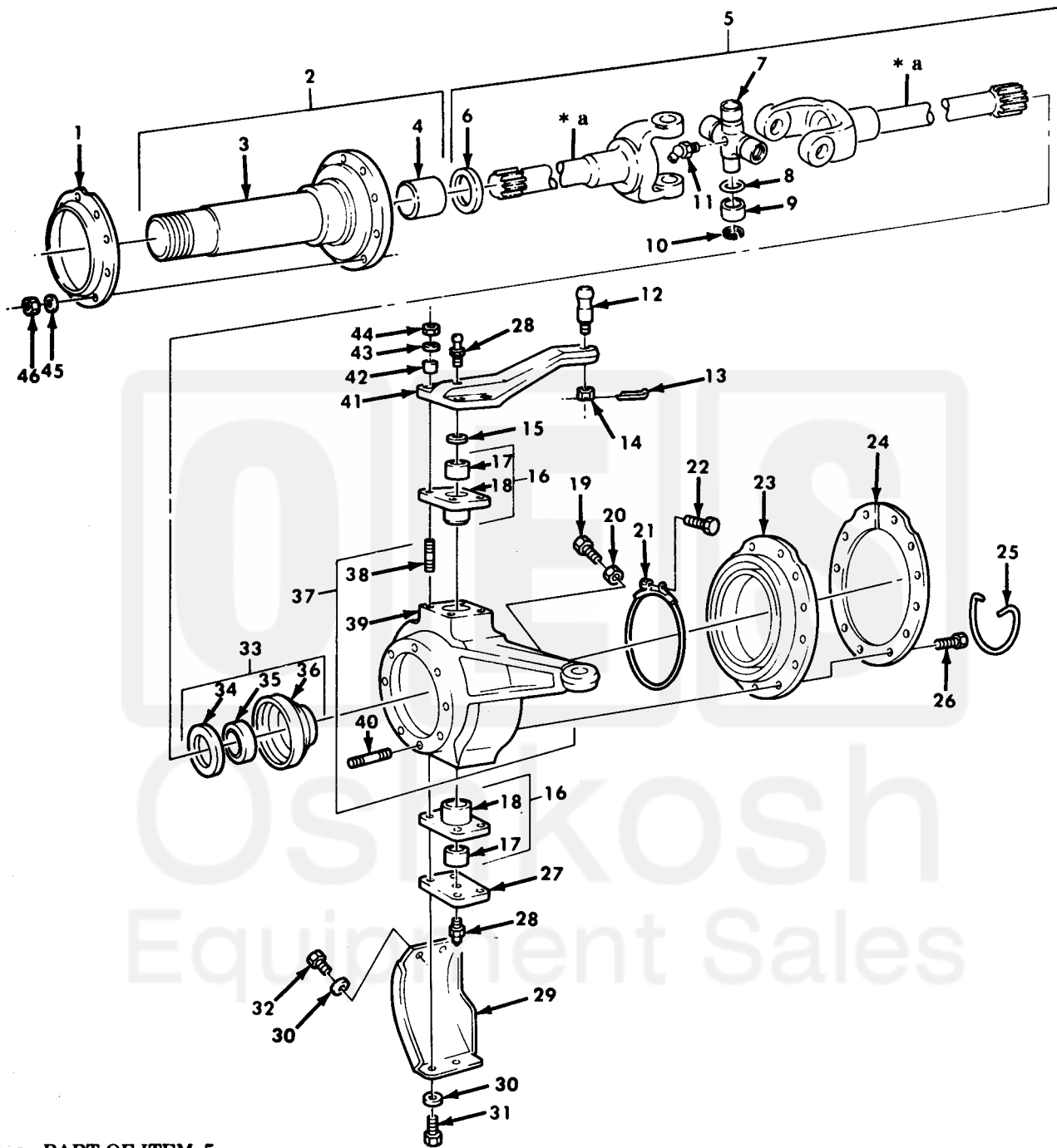

* a PART OF ITEM 5

TA 467905

Figure 172. Spindle Shaft Assembly, Universal Shaft, and Knuckle Assembly.

Current part is item (33) on diagram. Available at www.oshkoshequipment.com

(a) FIG. NO.	(b) ITEM NO.	SMR CODE	NATIONAL STOCK NUMBER	PART NUMBER	FSCM	DESCRIPTION USABLE ON CODE	U/M	(8) QTY INC IN UNIT
172	33	PAOOO	2520-00-734-6951	7346951	19207	SEAL ASSEMBLY	EA	2
172	34	PAOZZ	5310-00-033-6007	7346986	19207	WASHER, FLAT	EA	1
172	35	PAOZZ	5330-01-132-5312	10938292	19207	SEAL, PLAIN, ENCASED	EA	1
172	36	PAOZZ	5330-01-098-6668	8758268	19207	RETAINER, OIL SEAL	EA	1
172	37	PAFOO	2530-00-734-6815	7346815	19207	KNUCKLE ASSEMBLY LEFT	EA	1
172	37	PAFOO	2520-00-006-7469	7346816-1	19207	KNUCKLE ASSEMBLY RIGHT	EA	1
172	38	PAFZZ	5307-00-734-6900	7346900	19207	STUD, PLAIN	EA	4
172	39	XAFZZ		8758352	19207	HOUSING, FRONT AXLE LEFT	EA	1
172	39	XAFZZ		8758252-1	19207	HOUSING, FRONT AXLE RIGHT	EA	1
172	40	PAFZZ	5307-00-734-6811	7346811	19207	STUD, PLAIN	EA	10
172	41	PAFZZ	2530-01-088-9357	11664597-1	19207	ARM, STEERING LEFT	EA	1
172	41	PAFZZ	2530-00-231-0178	11664598	19207	ARM, STEERING RIGHT	EA	1
172	42	PAFZZ	5340-00-437-2282	7346812	19207	BUSHING, TAPERED	EA	8
172	43	PAFZZ	5310-00-800-0695	MS35335-39	96906	WASHER, LOCK	EA	8
172	44	PAFZZ	5310-00-274-7721	7346813	19207	NUT, PLAIN, HEXAGON	EA	8
172	45	PAOZZ	5310-00-616-6354	MS35335-33	96906	WASHER, LOCK	EA	20
172	46	PAOZZ	5310-00-763-8711	MS51968-17	96906	NUT, PLAIN, HEXAGON	EA	20

END OF FIGURE



Current part is item (33) on diagram. Available at www.oshkoshequipment.com